

NATIONAL 4-H Youth Conference Center

Where Youth Stay at the Center of It All

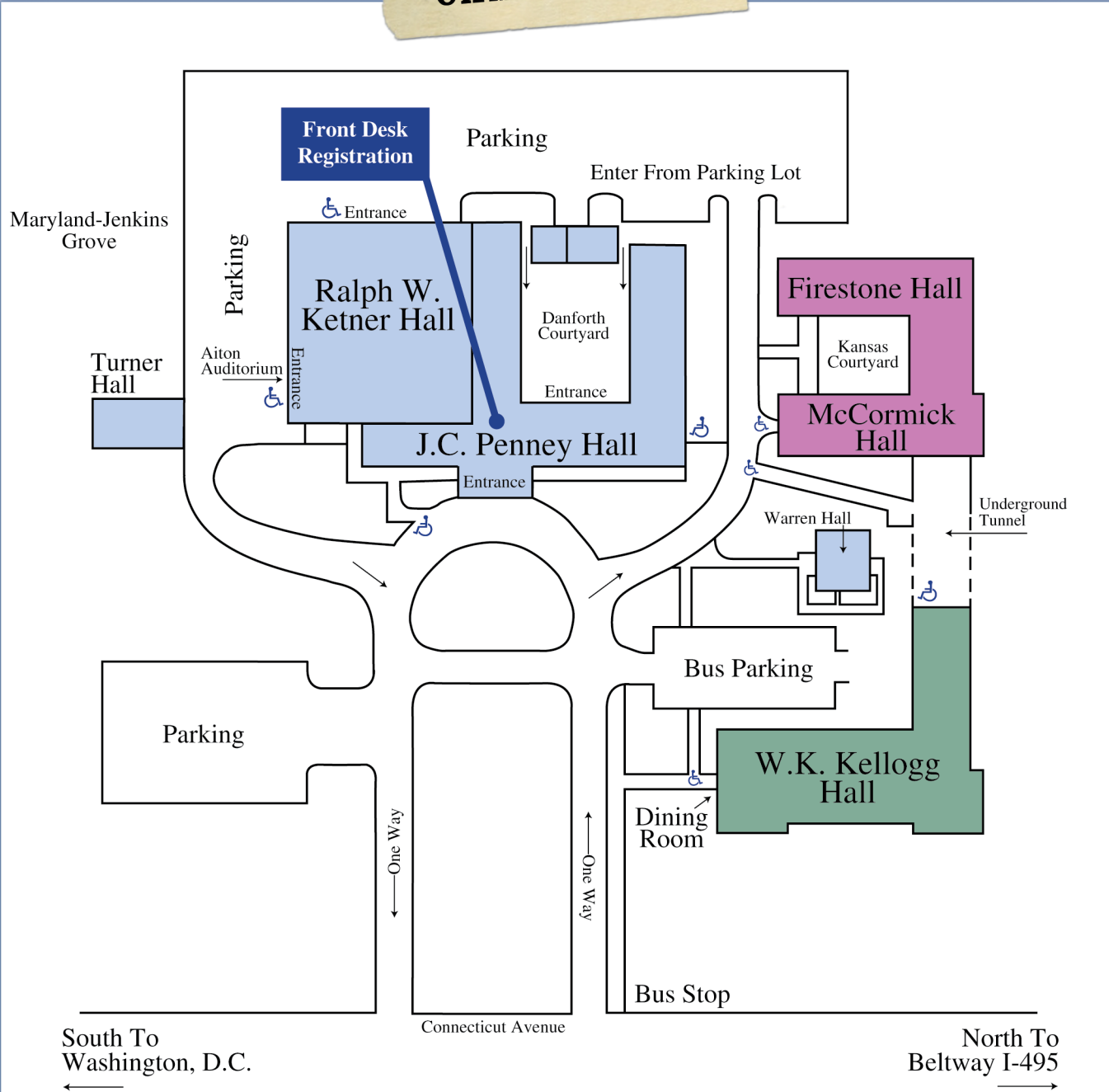

CAMPUS MAP



INTERIOR CAMPUS MAP



KEY

- Dorm Rooms
- Meeting Rooms
- Lounges
- Administrative Offices
- Roof
- Tennessee Dining/Clover Cafe
- Courtyards
- Bus Parking
- Rest Rooms - Women
- Rest Rooms - Men
- Ice/Vending Machines
- Phone
- Stairs
- Rest Rooms - Women
- Rest Rooms - Men
- Ice/Vending Machines
- Phone
- Stairs
- Laundry Room
- Accessible Entrance
- Elevator

LOWER LEVEL

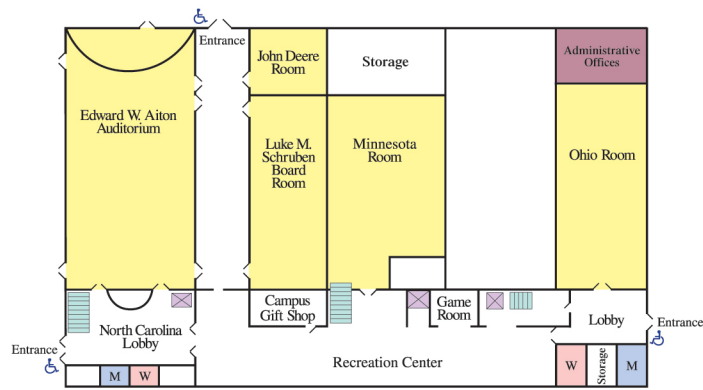

KETNER HALL J.C. PENNEY HALL

GROUND FLOOR

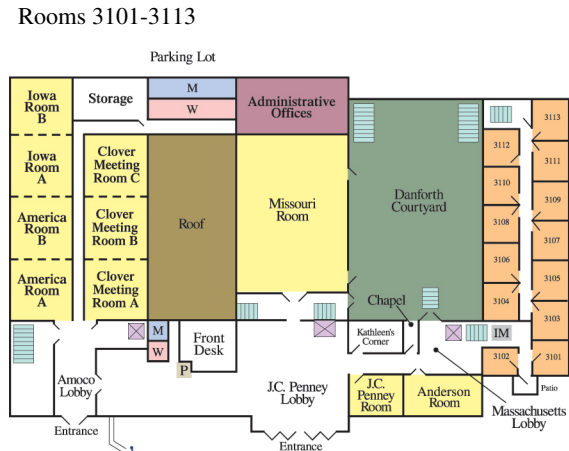

KETNER HALL J.C. PENNEY HALL

SECOND FLOOR

Rooms 1201-1216
Rooms 3201-3213

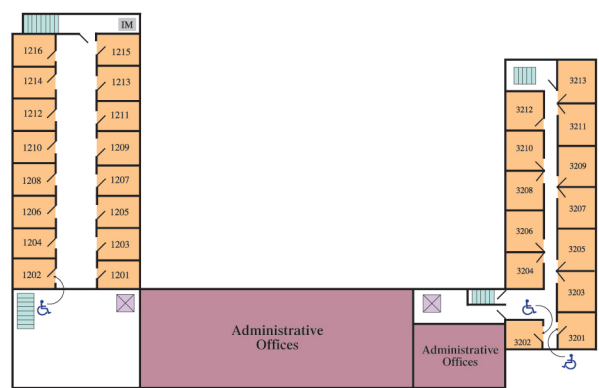

KETNER HALL J.C. PENNEY HALL

THIRD FLOOR

Rooms 1301-1316

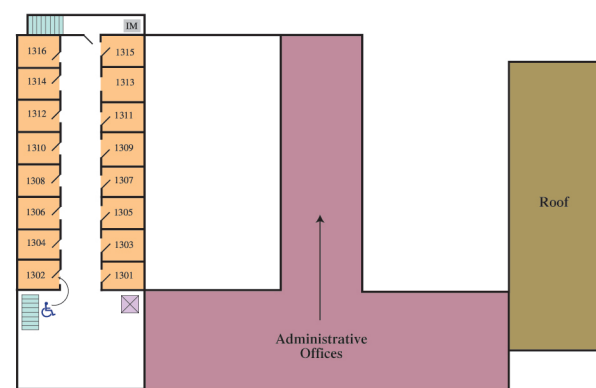

KETNER HALL J.C. PENNEY HALL

LOWER LEVEL

Rooms 4001-4010

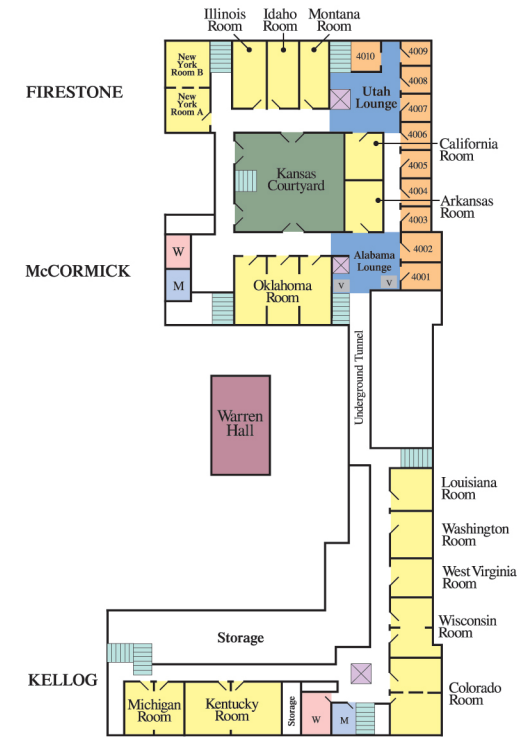

GROUND FLOOR

Rooms 4151-5111

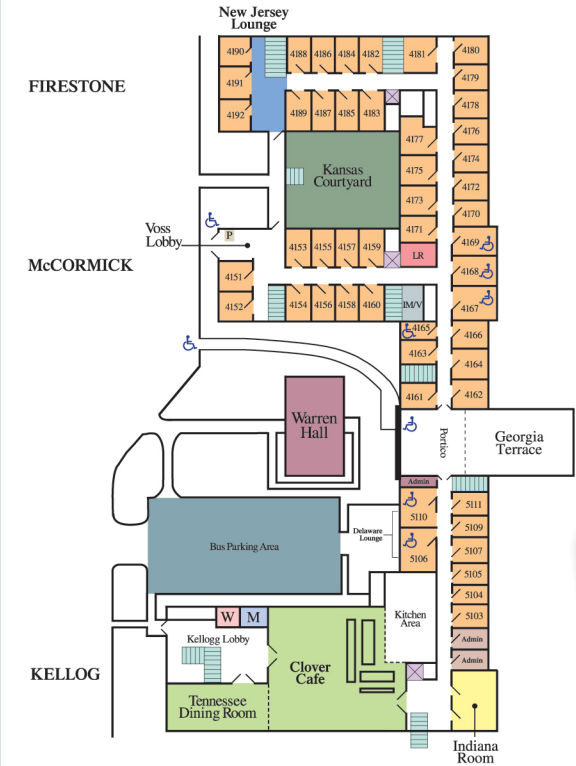

SECOND FLOOR

Rooms 4251-5241

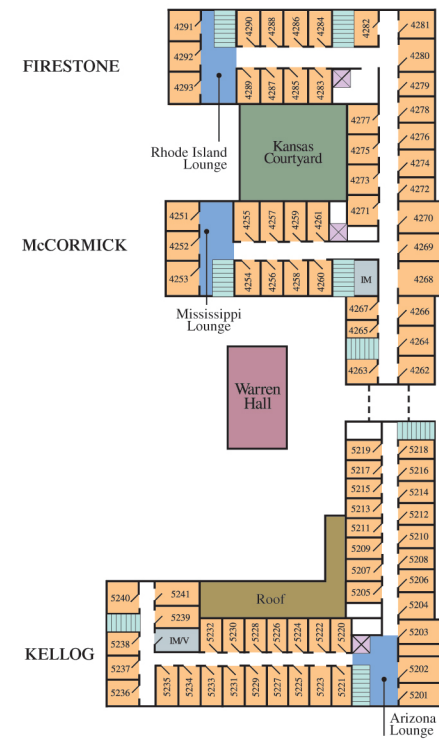

THIRD FLOOR

Rooms 4351-5522

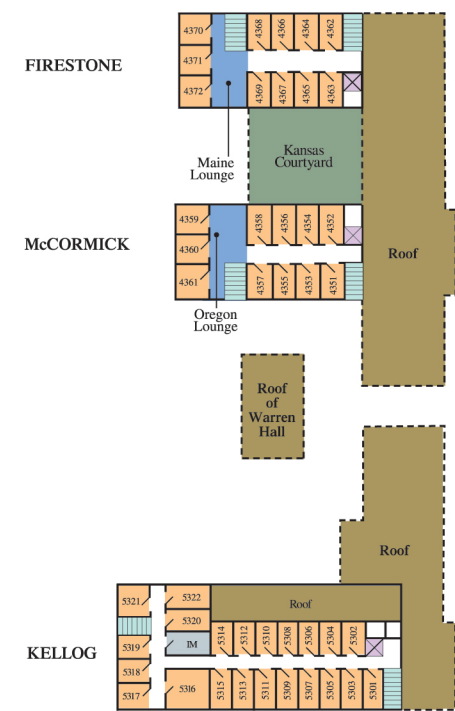

About National 4-H Youth Conference Center

- 12 acre campus just one mile from Washington, DC
- Accommodates up to 800 overnight guests
- Quad, triple, double and single room occupancy with private bathroom
- 41 meeting rooms totaling 44,000 square feet of meeting space
- State-of-the-art recreation center and Cyber Café
- Outdoor basketball and sand volleyball courts
- “All you can eat” café-style dining
- Minutes to the Metro, 495 Capital Beltway and I-95



AREA MAP

